

Water Miser Battery Vent Cap

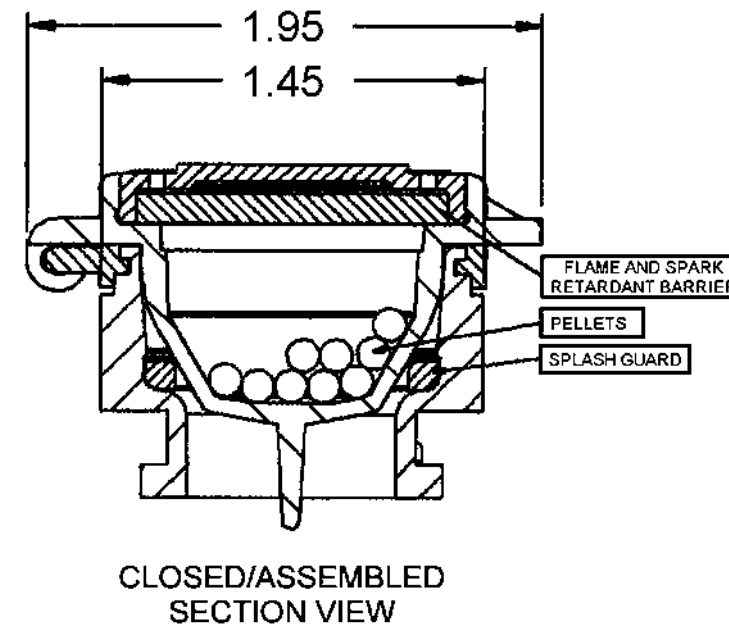
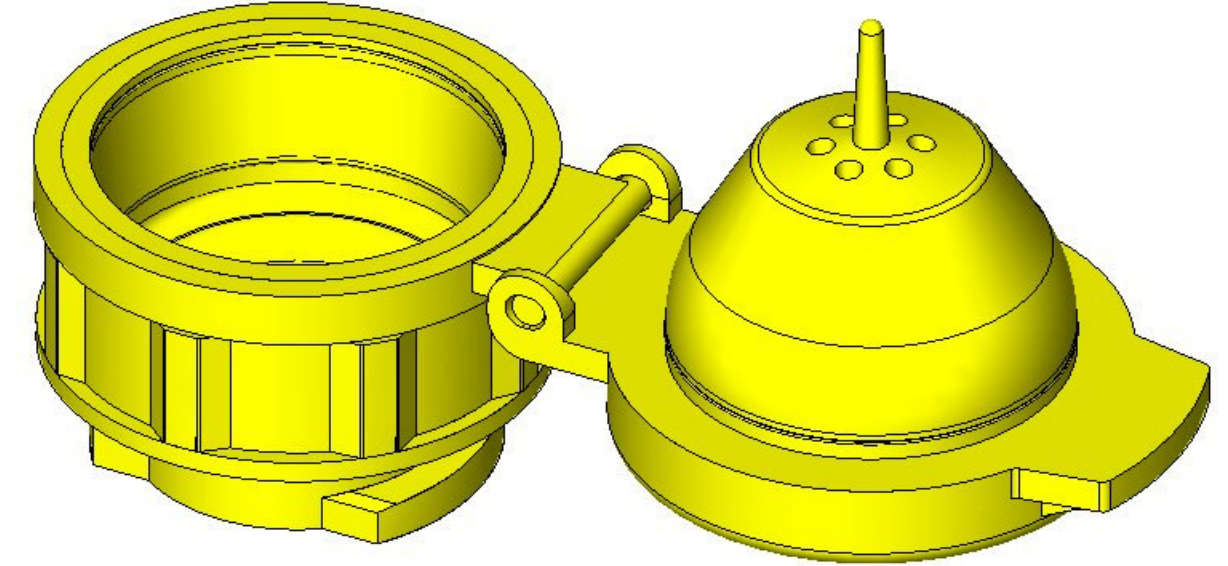
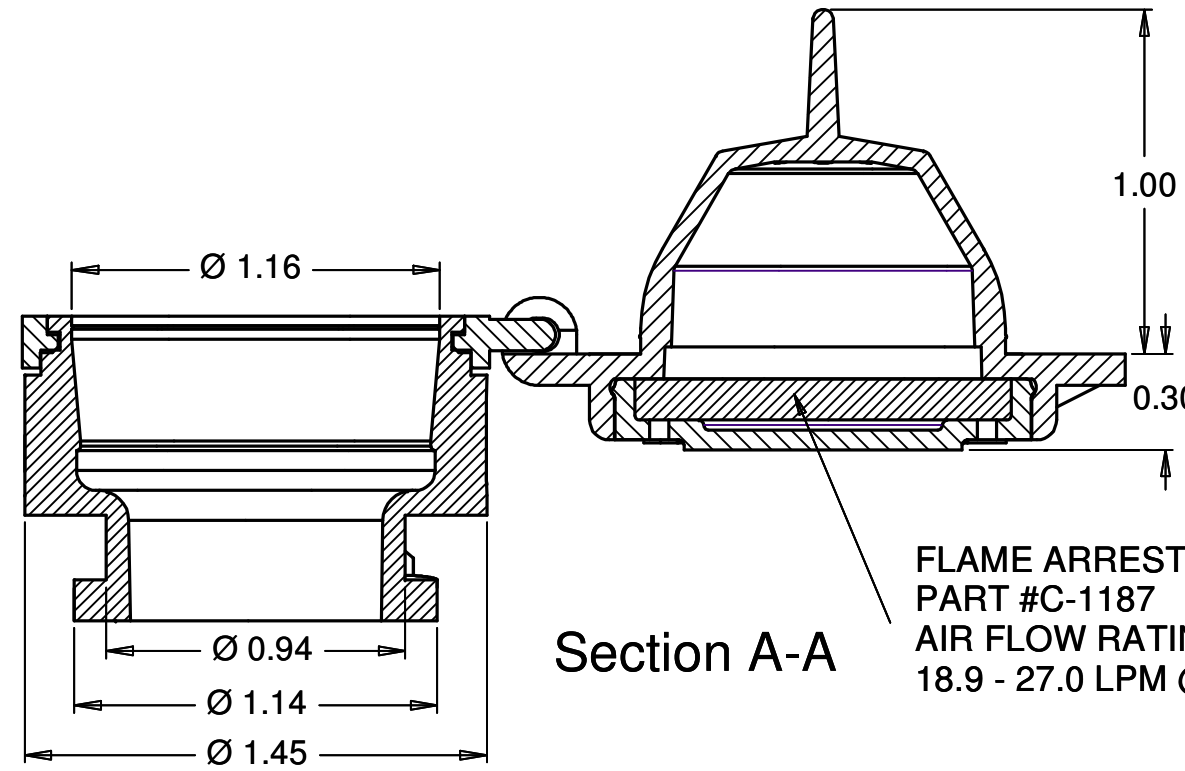
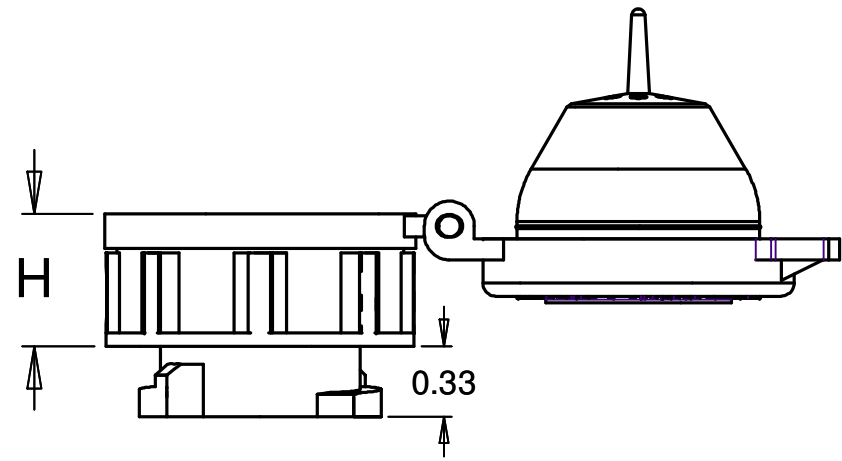
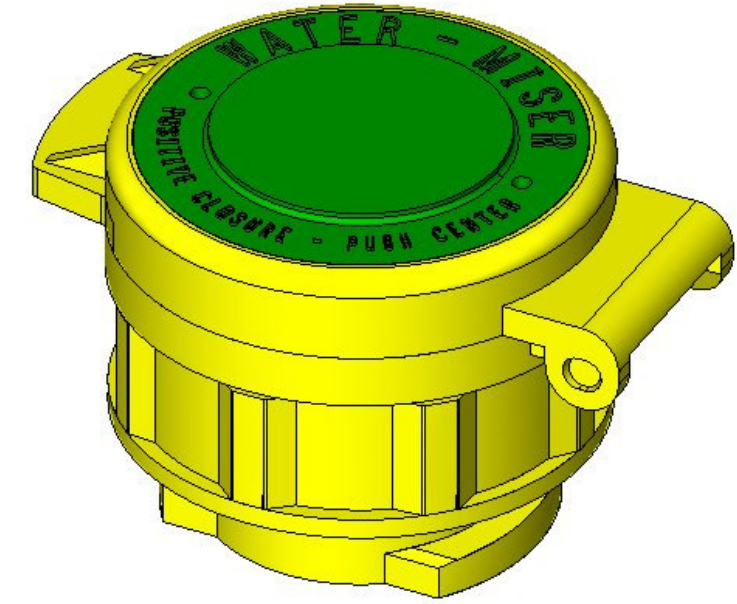
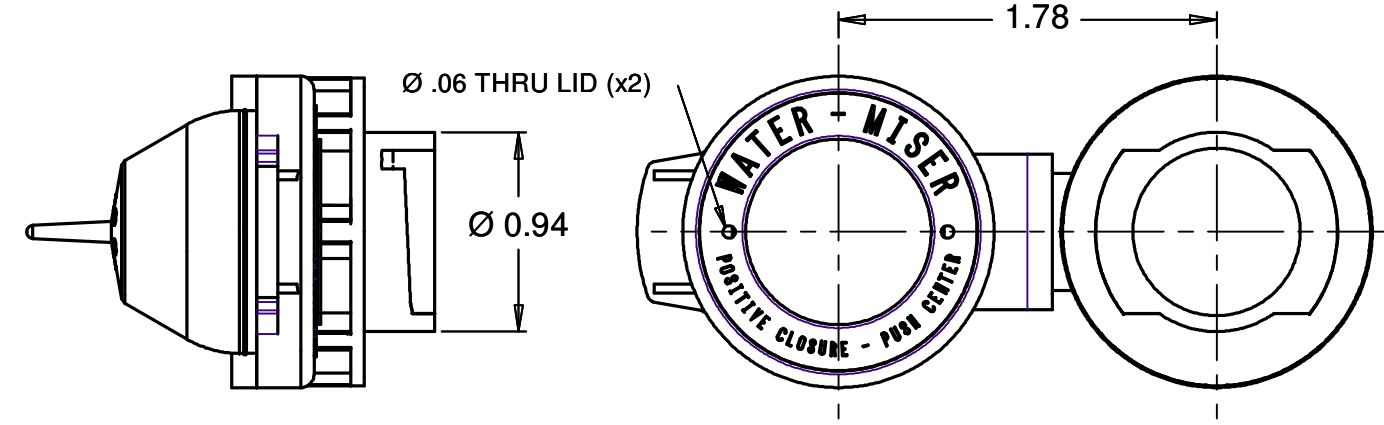
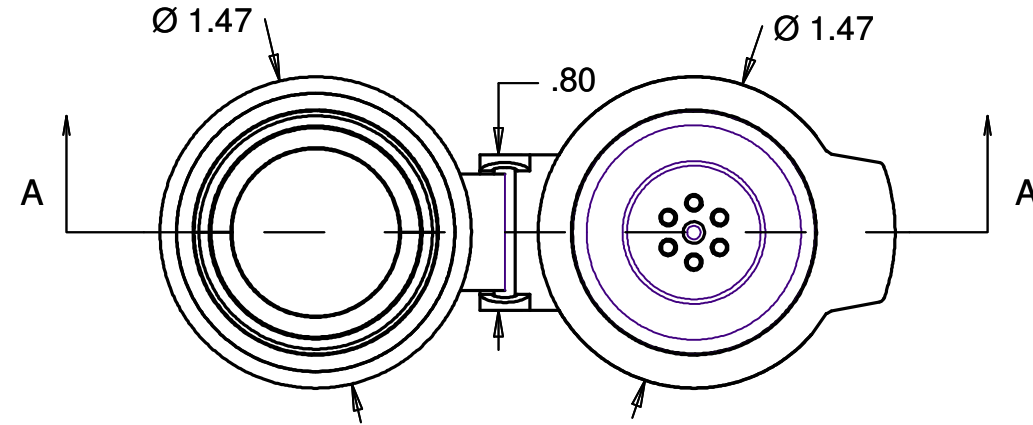

PART NAME	PART #	DIM. H
WATER MISER BATTERY VENT CAP	2000	.63
WATER MISER MEDIUM BODY BATTERY VENT CAP	2000C	.95
WATER MISER EXTENDED BODY BATTERY VENT CAP	2000EX	1.13

REVISION	DESCRIPTION	BY	DATE

DRAWN D. WATERS TOLERANCE UNLESS SPECIFIED .X = +/- .060 .XX = +/- .030	DATE .XXX = +/- .010 .XXXX = +/- .005	DOYLE MANUFACTURING INC. MAKING PLASTIC MOLDS SINCE 1975. 1440 HOLLOWAY ROAD HOLLAND, OHIO 43528 QUALITY CERTIFIED ISO/TS16949:2002
CUSTOMER SHAMROCK	PART NO. SEE CHART	PART NAME SEE CHART
MATERIAL PP	SHRINKAGE	JOB #
COLOR	UNITS INCHES	SHT 1 OF 1

THIS DOCUMENT CONTAINS CONFIDENTIAL AND PROPRIETARY INFORMATION, AND MAY NOT BE USED, COPIED OR DISCLOSED IN WHOLE OR IN PART FOR ANY PURPOSE INCLUDING DESIGN OR MANUFACTURE WITHOUT THE PRIOR WRITTEN CONSENT OF DOYLE MANUFACTURING INC.